

- 註釋 NOTES:
1. 除另有說明外，所有量度以米為單位。
ALL DIMENSIONS ARE IN METRES UNLESS OTHERWISE STATED.
 2. 所有水平均為約數，以米為單位，並在香港主水平基準上。
ALL LEVELS ARE APPROXIMATE VALUES AND IN METRES ABOVE HONG KONG PRINCIPAL DATUM.
 3. 如有需要，施工區界限內部分現有行車道、行人路/小徑、露天地方、單車徑、路旁帶、中央分隔帶/安全島、行人過路處、停車灣及車輛出入通道或會分階段暫時封閉並改道。
SECTIONS OF THE EXISTING CARRIAGEWAYS, FOOTPATHS/TRACKS, OPEN SPACES, CYCLE TRACKS, VERGES, CENTRAL MEDIANS/TRAFFIC ISLANDS, PEDESTRIAN CROSSINGS, LAY-BYS AND RUN-INS/RUN-OUTS WITHIN THE LIMIT OF WORKS AREA MAY BE TEMPORARILY CLOSED AND DIVERTED IN PHASES AS AND WHEN REQUIRED.

圖例 LEGEND:
 施工區界限
 LIMIT OF WORKS AREA

Plot Date = 2022/12/12

連接圖則編號 199086/BIN/GP/002
 CONTINUED ON PLAN NO. 199086/BIN/GP/002

INSERT "A"
 插圖 "A"

INSERT "B"
 插圖 "B"

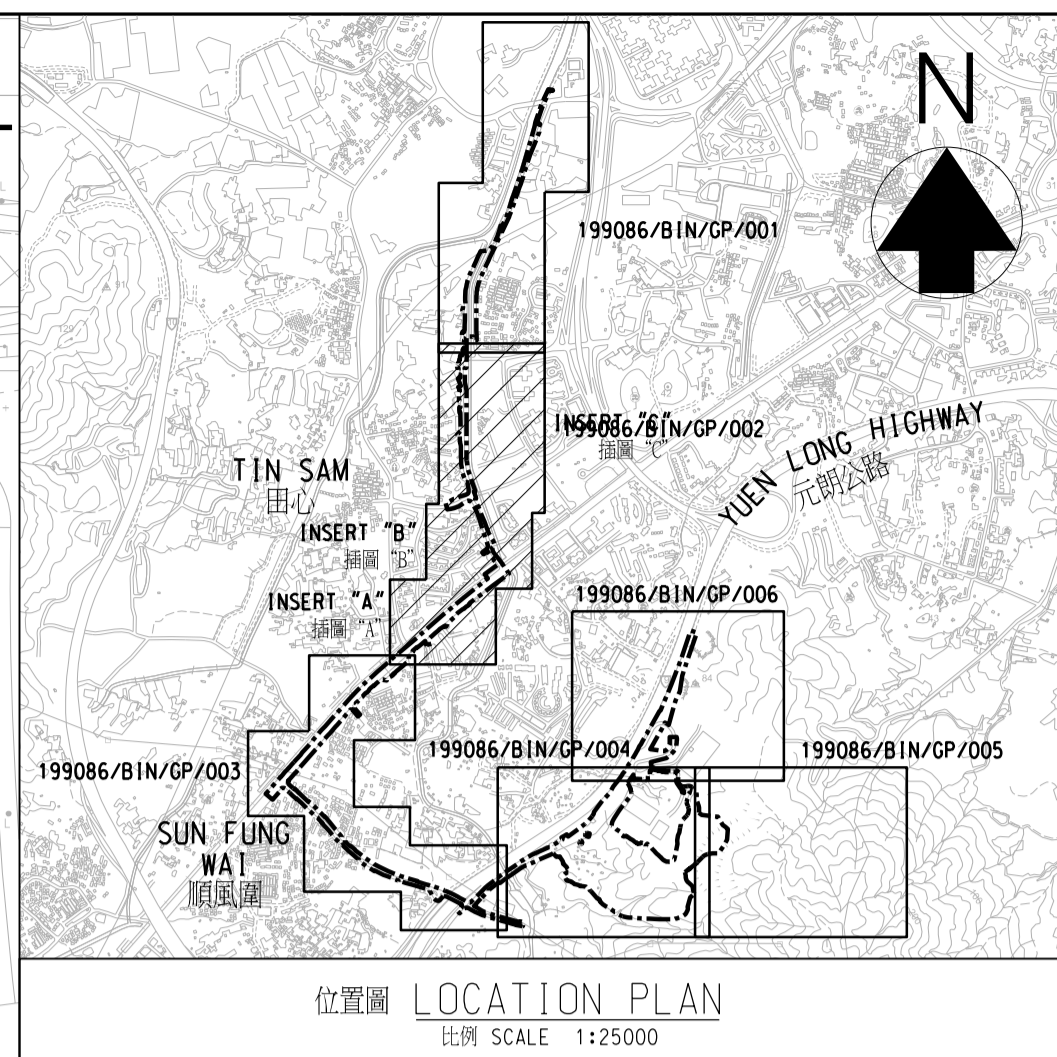
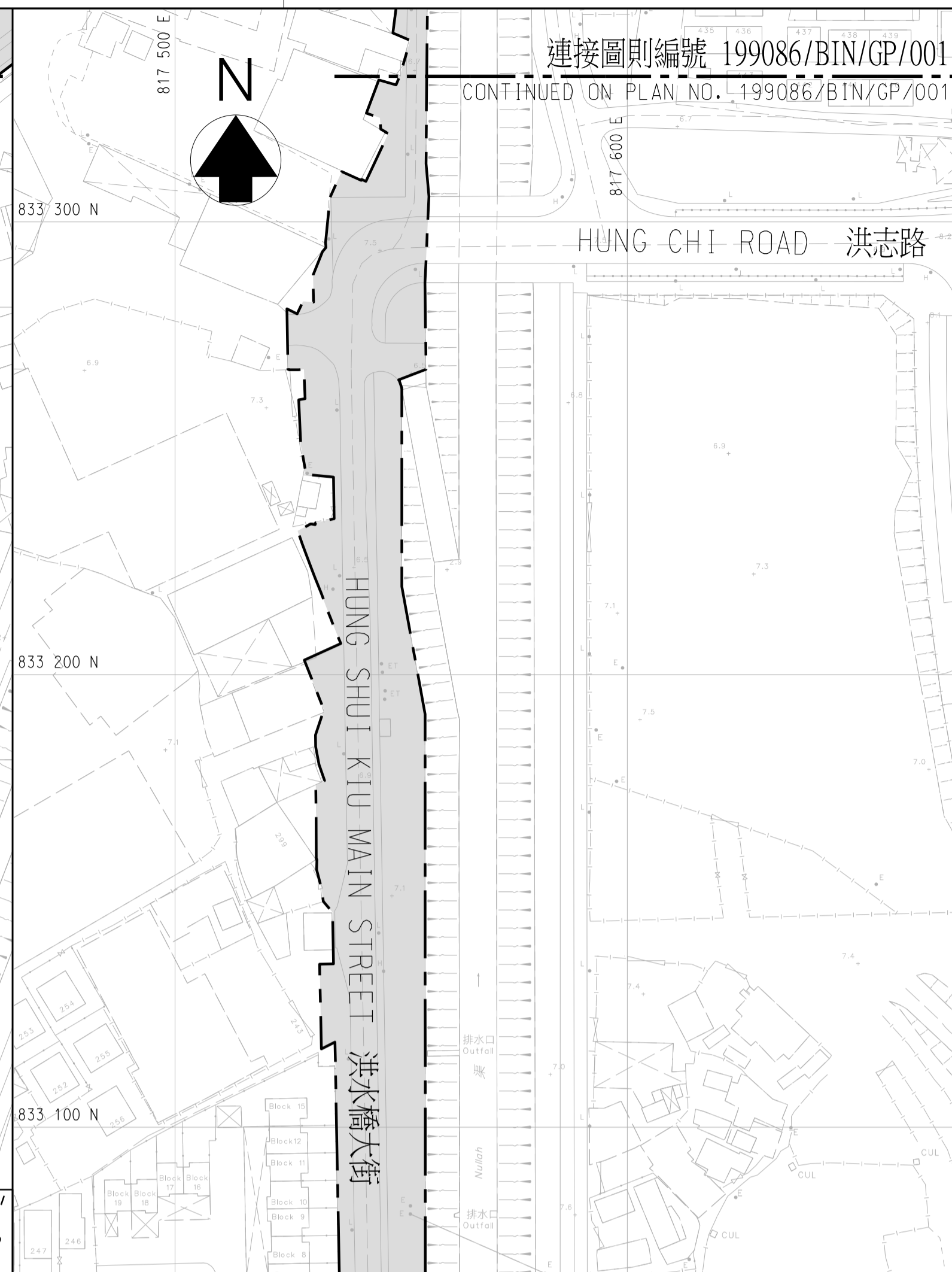
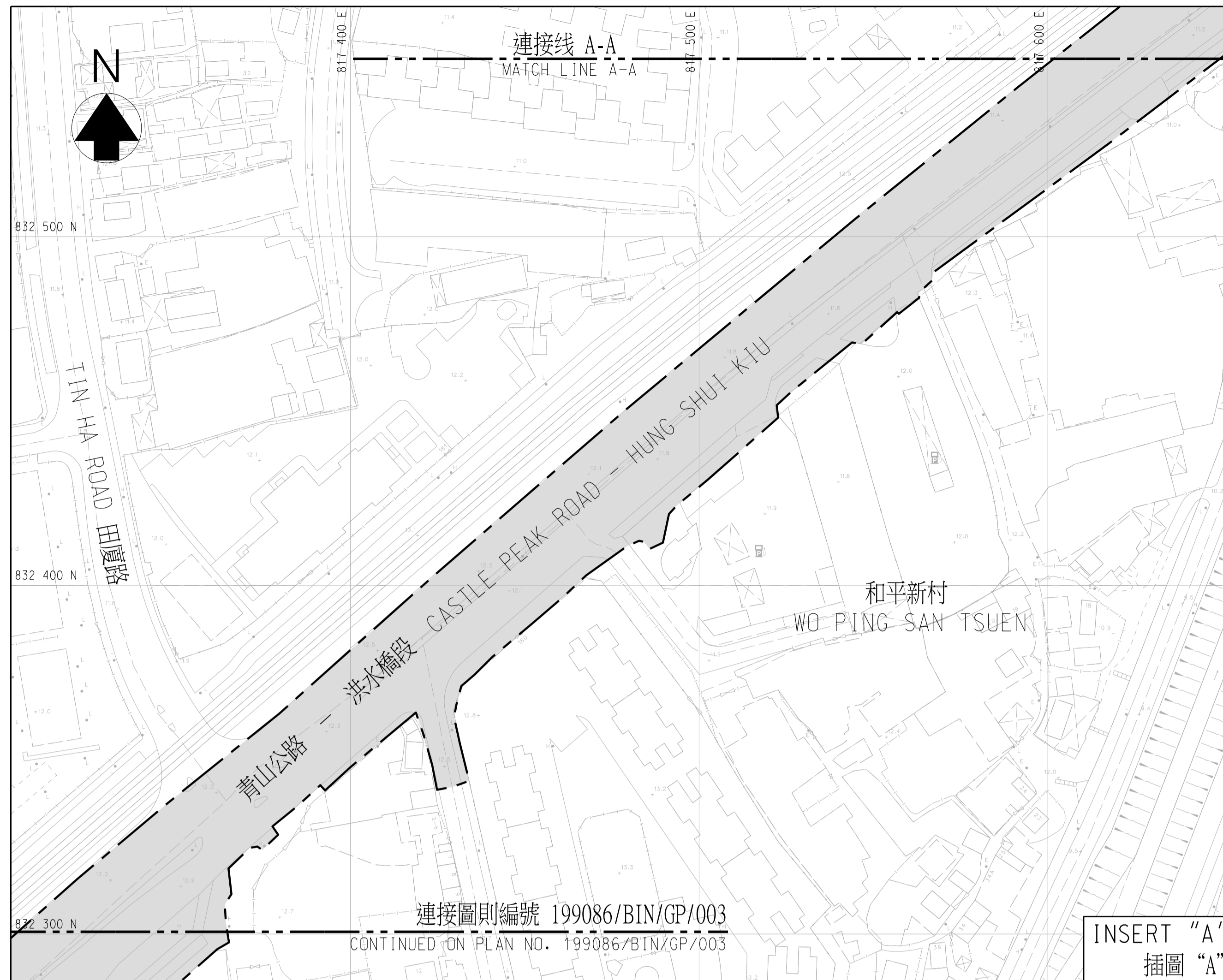

註釋 NOTES:

1. 除另有說明外，所有量度以米為單位。
ALL DIMENSIONS ARE IN METRES UNLESS OTHERWISE STATED.
2. 所有水平均為約數，以米為單位，並在香港主水平基準上。
ALL LEVELS ARE APPROXIMATE VALUES AND IN METRES ABOVE HONG KONG PRINCIPAL DATUM.
3. 如有需要，施工區界限內部分現有行車道、行人路/小徑、露天地方、單車徑、路旁帶、中央分隔帶/安全島、行人過路處、停車灣及車輛出入通道或會分階段暫時封閉並改道。
SECTIONS OF THE EXISTING CARRIAGEWAYS, FOOTPATHS/TRACKS, OPEN SPACES, CYCLE TRACKS, VERGES, CENTRAL MEDIANS/TRAFFIC ISLANDS, PEDESTRIAN CROSSINGS, LAY-BYS AND RUN-INS/RUN-OUTS WITHIN THE LIMIT OF WORKS AREA MAY BE TEMPORARILY CLOSED AND DIVERTED IN PHASES AS AND WHEN REQUIRED.

圖例 LEGEND:

--- 施工區界限
--- LIMIT OF WORKS AREA

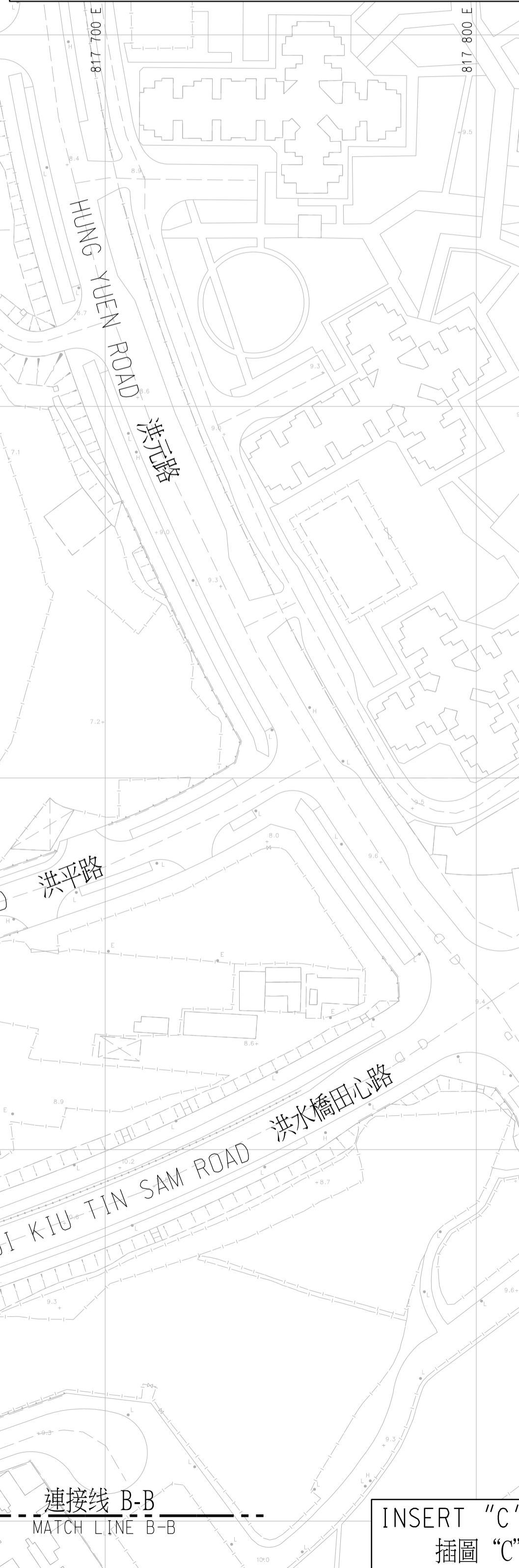
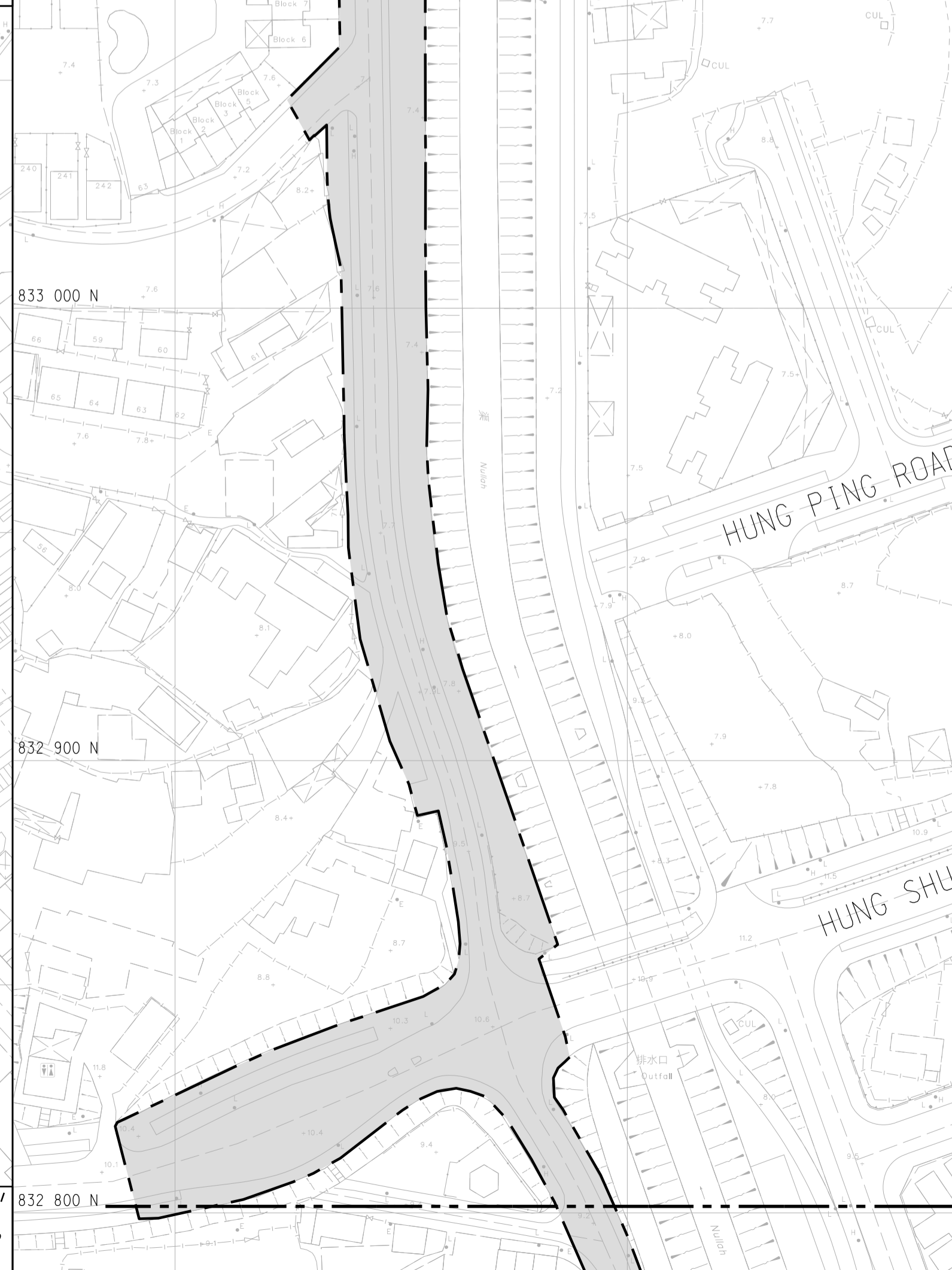
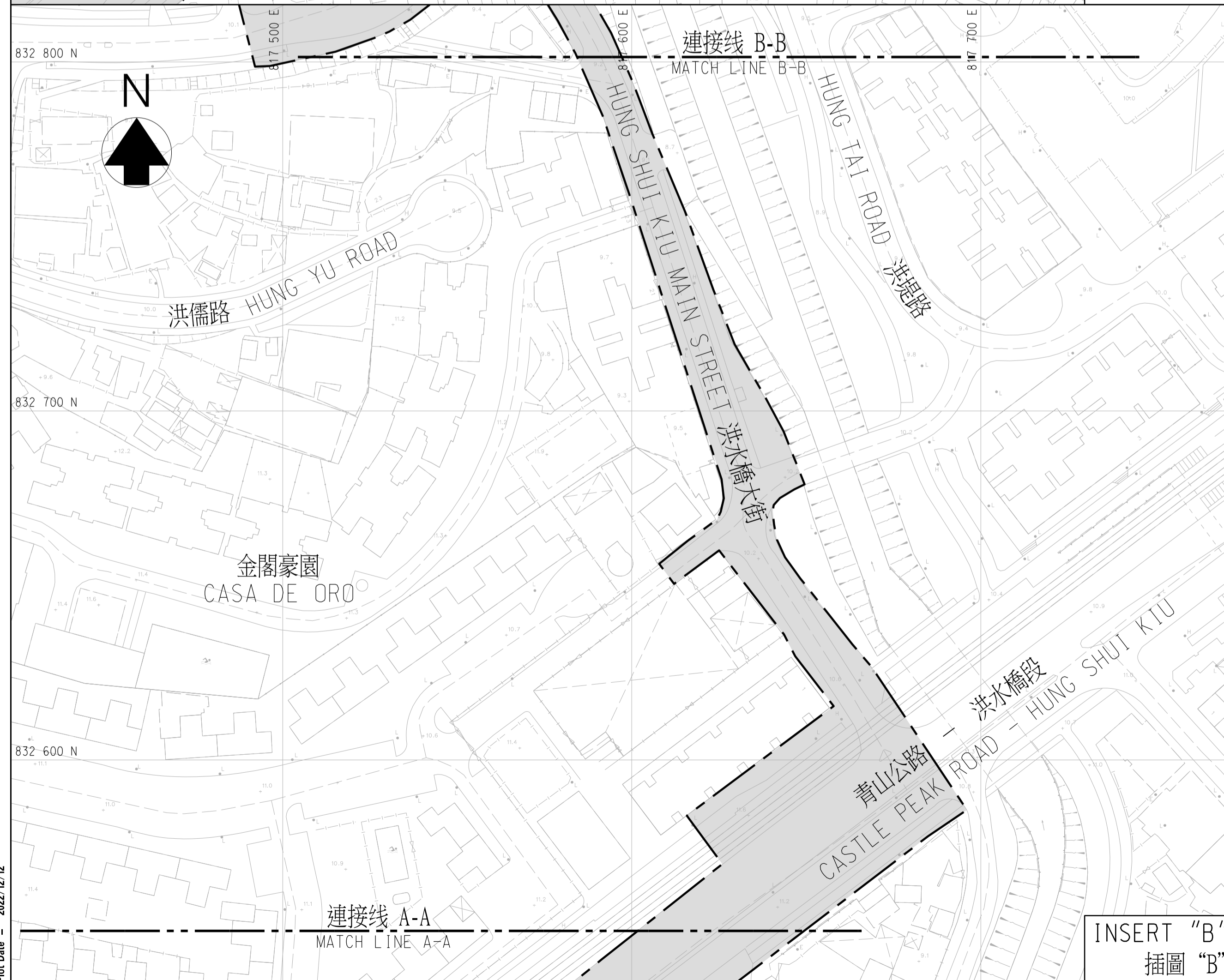

第2頁 共6頁
SHEET 2 OF 6

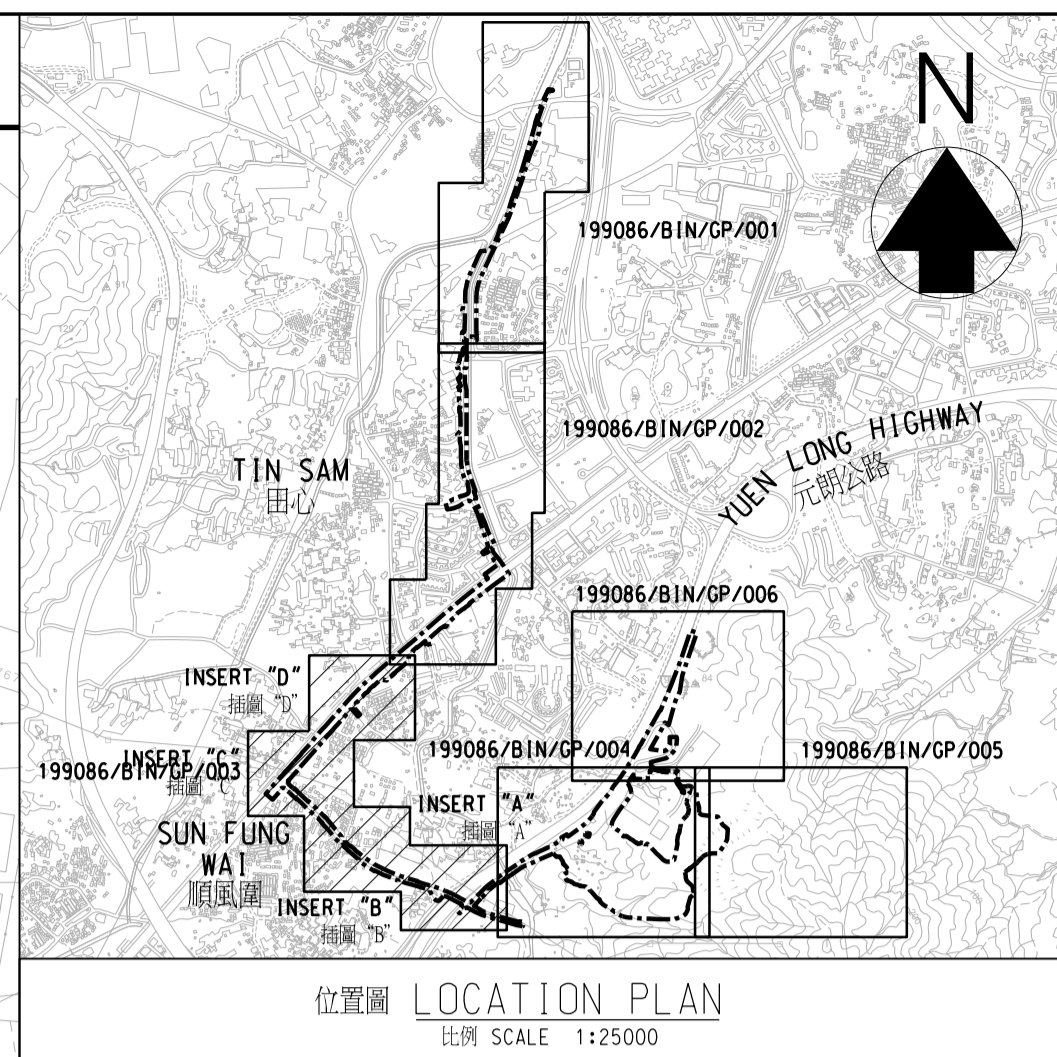
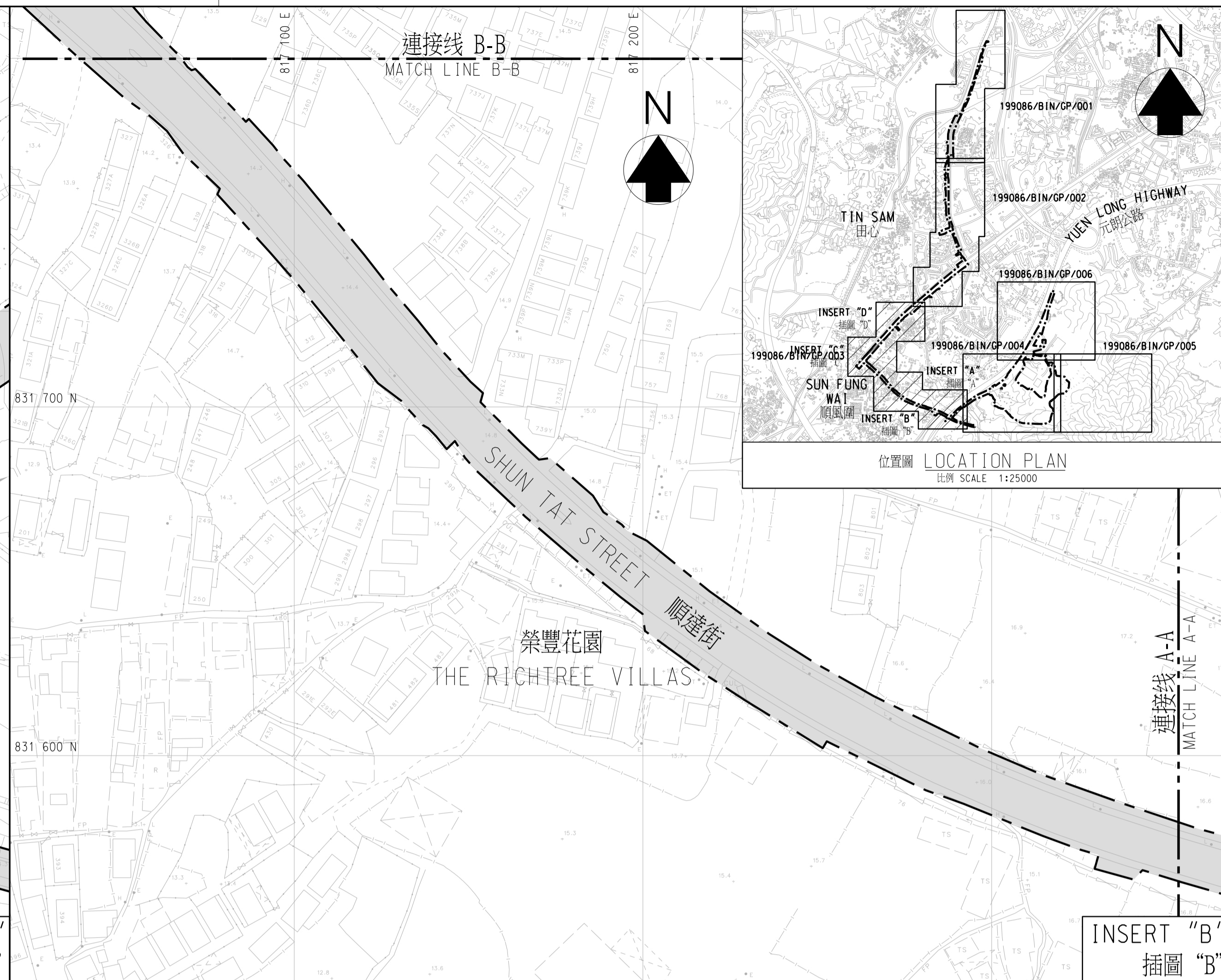
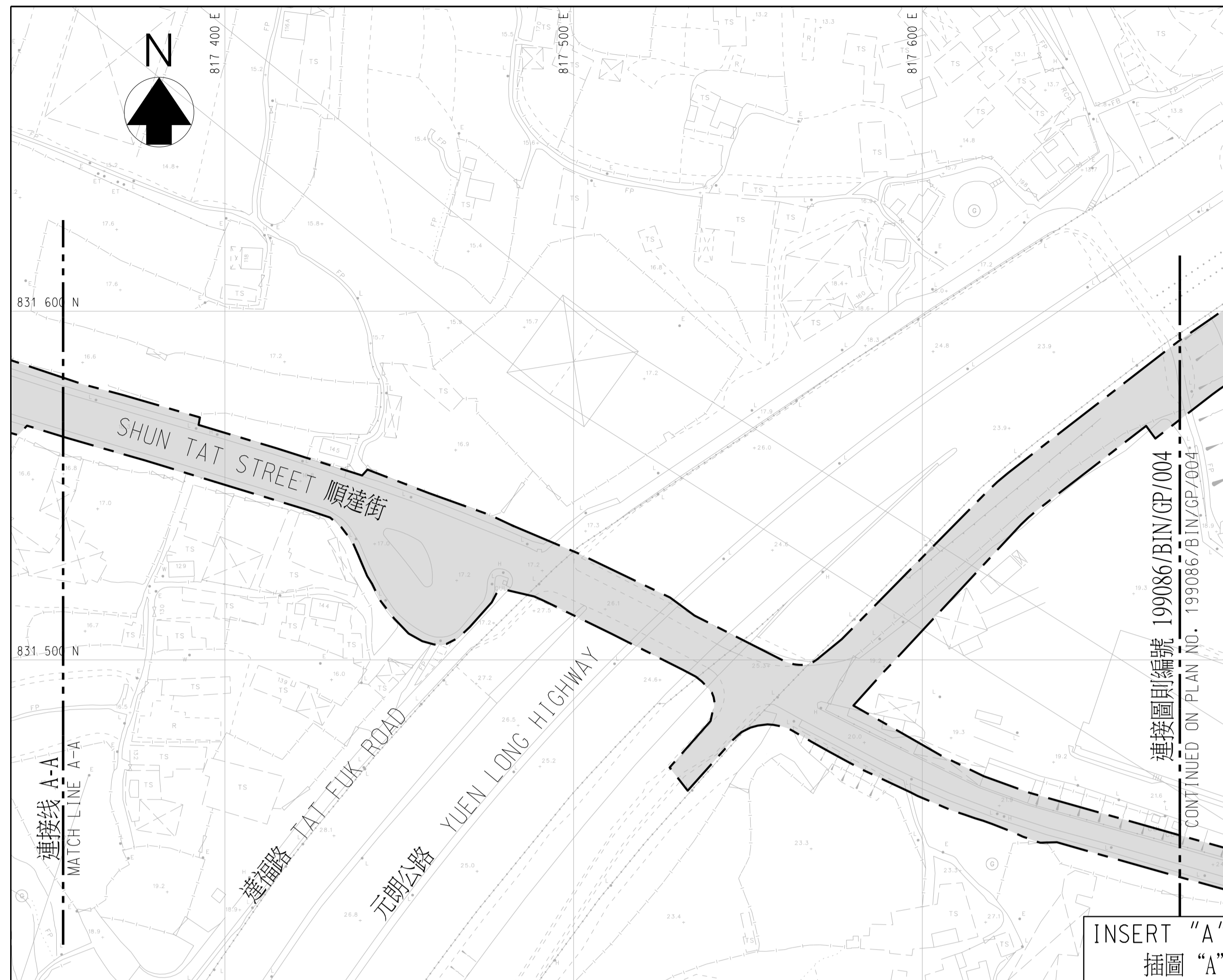

註釋 NOTES:

- 除另有說明外，所有量度以米為單位。
ALL DIMENSIONS ARE IN METRES UNLESS OTHERWISE STATED.
- 所有水平均為約數，以米為單位，並在香港主水平基準上。
ALL LEVELS ARE APPROXIMATE VALUES AND IN METRES ABOVE HONG KONG PRINCIPAL DATUM.
- 如有需要，施工區界限內部分現有行車道、行人路/小徑、露天地方、單車徑、路旁帶、中央分隔帶/安全島、行人過路處、停車灣及車輛出入通道或會分段暫時封閉並改道。
SECTIONS OF THE EXISTING CARRIAGEWAYS, FOOTPATHS/TRACKS, OPEN SPACES, CYCLE TRACKS, VERGES, CENTRAL MEDIANS/TRAFFIC ISLANDS, PEDESTRIAN CROSSINGS, LAY-BYS AND RUN-INS/RUN-OUTS WITHIN THE LIMIT OF WORKS AREA MAY BE TEMPORARILY CLOSED AND DIVERTED IN PHASES AS AND WHEN REQUIRED.

圖例 LEGEND:

--- 施工區界限
--- LIMIT OF WORKS AREA

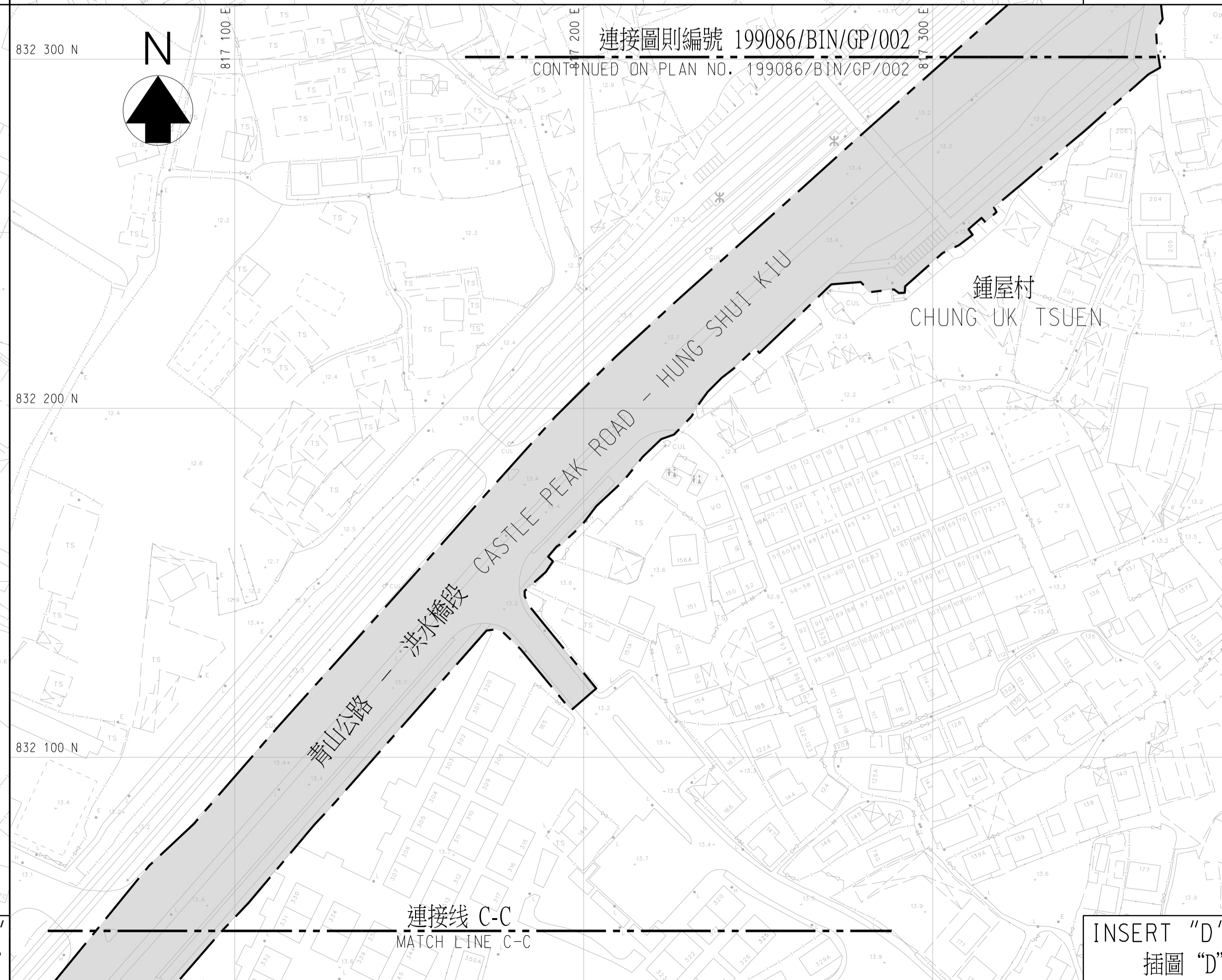

Plot Date = 2022/12/12

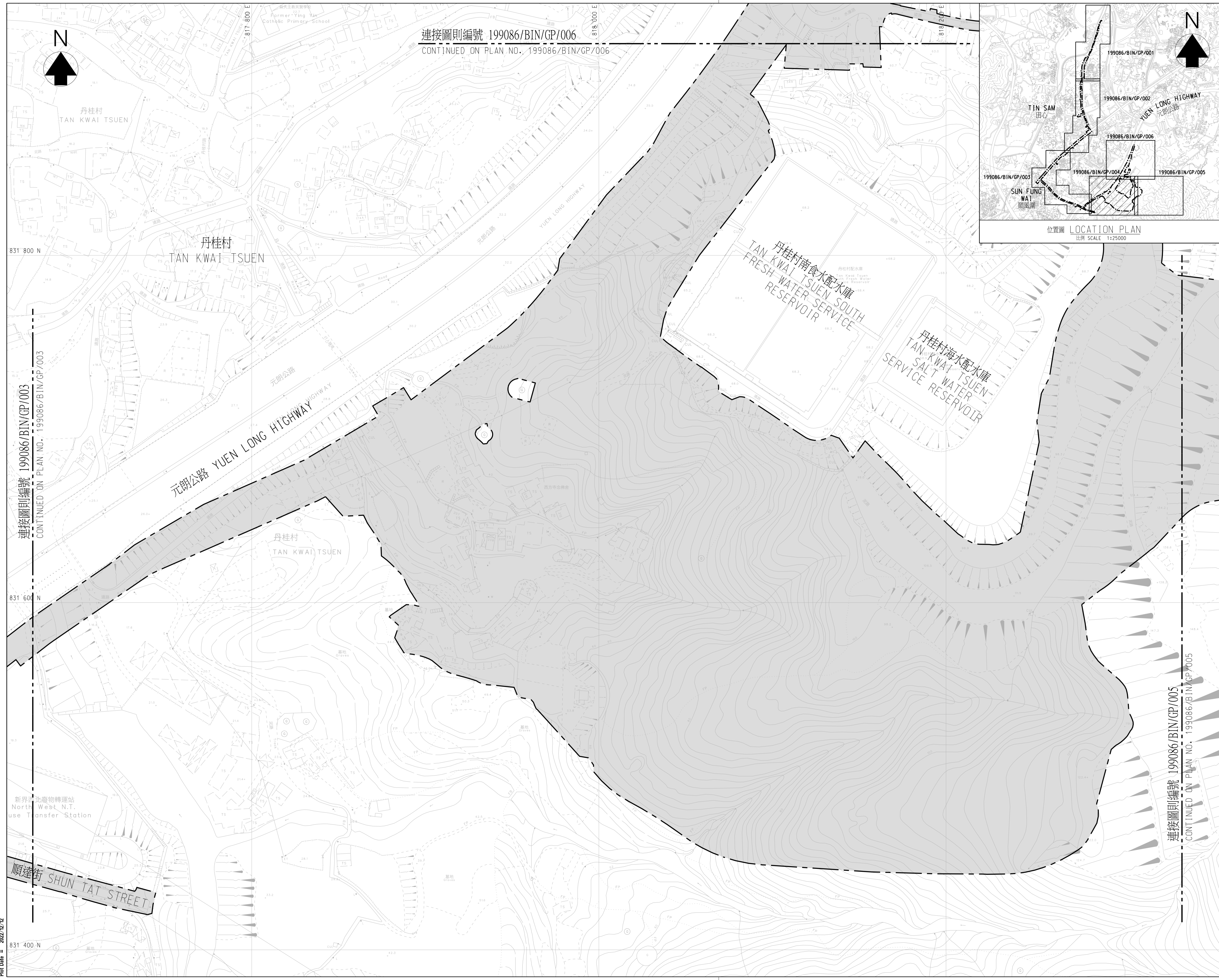

連接圖則編號 199086/BIN/GP/006
CONTINUED ON PLAN NO. 199086/BIN/GP/006

連接圖則編號 199086/BIN/GP/003
CONTINUED ON PLAN NO. 199086/BIN/GP/003

連接圖則編號 199086/BIN/GP/005
CONTINUED ON PLAN NO. 199086/BIN/GP/005

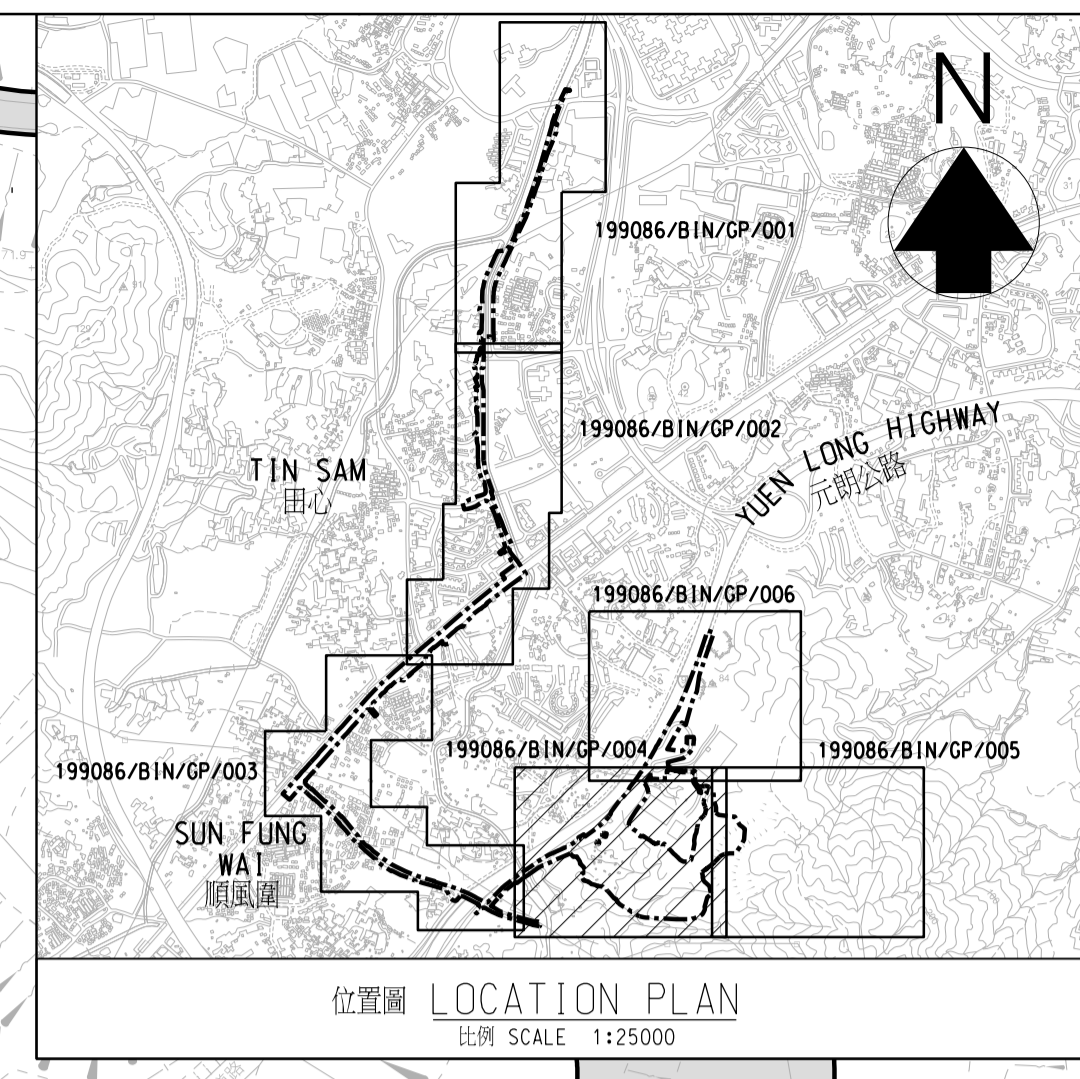

- 註釋 NOTES:
1. 除另有說明外，所有量度以米為單位。
ALL DIMENSIONS ARE IN METRES UNLESS OTHERWISE STATED.
 2. 所有水平均為約數，以米為單位，並在香港主水平基準上。
ALL LEVELS ARE APPROXIMATE VALUES AND IN METRES ABOVE HONG KONG PRINCIPAL DATUM.
 3. 如有需要，施工區界限內部分現有行車道、行人路/小徑、露天地方、單車徑、路旁帶、中央分隔帶/安全島、行人過路處、停車灣及車輛出入通道或會分段暫時封閉並改道。
SECTIONS OF THE EXISTING CARRIAGEWAYS, FOOTPATHS/TRACKS, OPEN SPACES, CYCLE TRACKS, VERGES, CENTRAL MEDIANS/TRAFFIC ISLANDS, PEDESTRIAN CROSSINGS, LAY-BYS AND RUN-INS/RUN-OUTS WITHIN THE LIMIT OF WORKS AREA MAY BE TEMPORARILY CLOSED AND DIVERTED IN PHASES AS AND WHEN REQUIRED.

圖例 LEGEND:
 施工區界限
 LIMIT OF WORKS AREA

Plot Date = 2022/12/12

新界西北廢物轉運站
North West N.T.
Use Transfer Station

順達街 SHUN TAT STREET

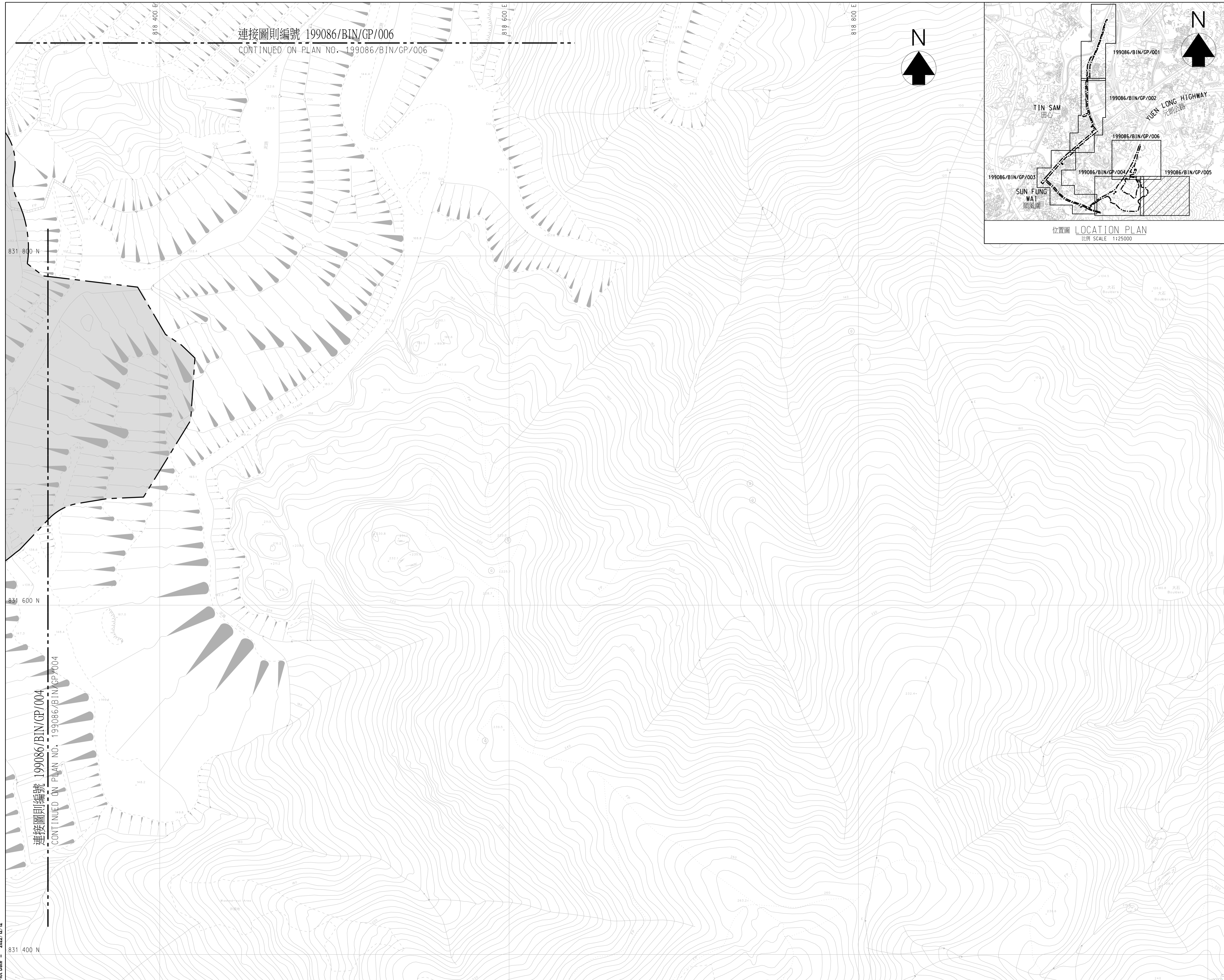

連接圖則編號 199086/BIN/GP/006
CONTINUED ON PLAN NO. 199086/BIN/GP/006

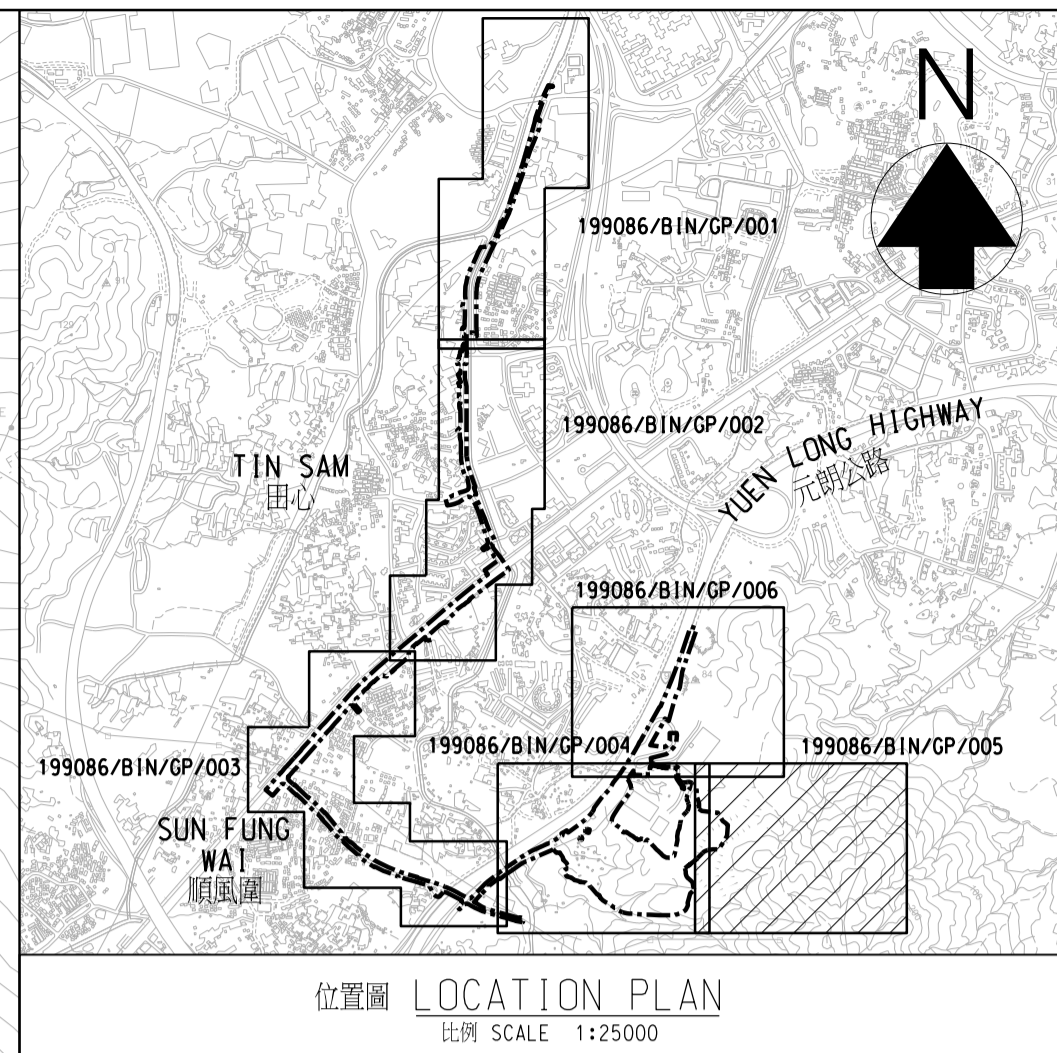
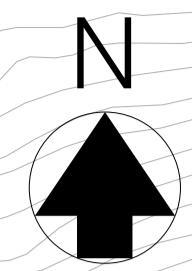

- 註釋 NOTES:
1. 除另有說明外，所有量度以米為單位。
ALL DIMENSIONS ARE IN METRES UNLESS OTHERWISE STATED.
 2. 所有水平均為約數，以米為單位，並在香港主水平基準上。
ALL LEVELS ARE APPROXIMATE VALUES AND IN METRES ABOVE HONG KONG PRINCIPAL DATUM.
 3. 如有需要，施工區界限內部分現有行車道、行人路/小徑、露天地方、單車徑、路旁帶、中央分隔帶/安全島、行人過路處、停車灣及車輛出入通道或會分階段暫時封閉並改道。
SECTIONS OF THE EXISTING CARRIAGEWAYS, FOOTPATHS/TRACKS, OPEN SPACES, CYCLE TRACKS, VERGES, CENTRAL MEDIANS/TRAFFIC ISLANDS, PEDESTRIAN CROSSINGS, LAY-BYS AND RUN-INS/RUN-OUTS WITHIN THE LIMIT OF WORKS AREA MAY BE TEMPORARILY CLOSED AND DIVERTED IN PHASES AS AND WHEN REQUIRED.

圖例 LEGEND:

 施工區界限
 LIMIT OF WORKS AREA

Plot Date = 2022/12/12

連接圖則編號 199086/BIN/GP/004
CONTINUED ON PLAN NO. 199086/BIN/GP/004

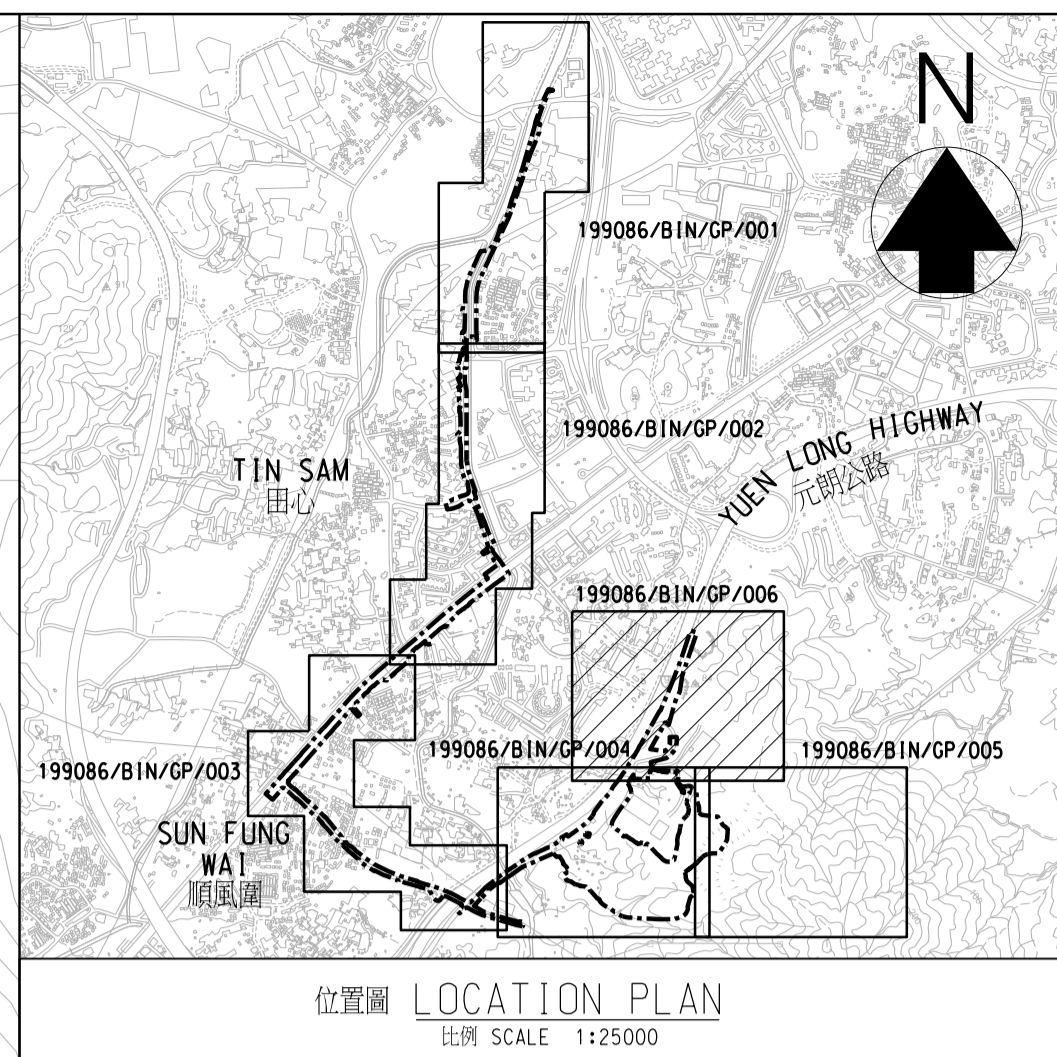

位置圖 LOCATION PLAN
比例 SCALE 1:25000

- 註釋 NOTES:
1. 除另有說明外，所有量度以米為單位。
ALL DIMENSIONS ARE IN METRES UNLESS OTHERWISE STATED.
 2. 所有水平均為約數，以米為單位，並在香港主水平基準上。
ALL LEVELS ARE APPROXIMATE VALUES AND IN METRES ABOVE HONG KONG PRINCIPAL DATUM.
 3. 如有需要，施工區界限內部分現有行車道、行人路/小徑、露天地方、單車徑、路旁帶、中央分隔帶/安全島、行人過路處、停車灣及車輛出入通道或會分階段暫時封閉並改道。
SECTIONS OF THE EXISTING CARRIAGEWAYS, FOOTPATHS/TRACKS, OPEN SPACES, CYCLE TRACKS, VERGES, CENTRAL MEDIANS/TRAFFIC ISLANDS, PEDESTRIAN CROSSINGS, LAY-BYS AND RUN-INS/RUN-OUTS WITHIN THE LIMIT OF WORKS AREA MAY BE TEMPORARILY CLOSED AND DIVERTED IN PHASES AS AND WHEN REQUIRED.

圖例 LEGEND:
 施工區界限
 LIMIT OF WORKS AREA

丹桂村北食水配水庫
 TAN KWAI TSUEN NORTH
 FRESH WATER SERVICE
 RESERVOIR

連接圖則編號 199086/BIN/GP/005
 CONTINUED ON PLAN NO. 199086/BIN/GP/005

Plot Date = 2022/12/12